



Falcon
lettings

01752 600828

60 Holne Chase

Widewell, Plymouth, PL6 7UB

£1,350 pcm

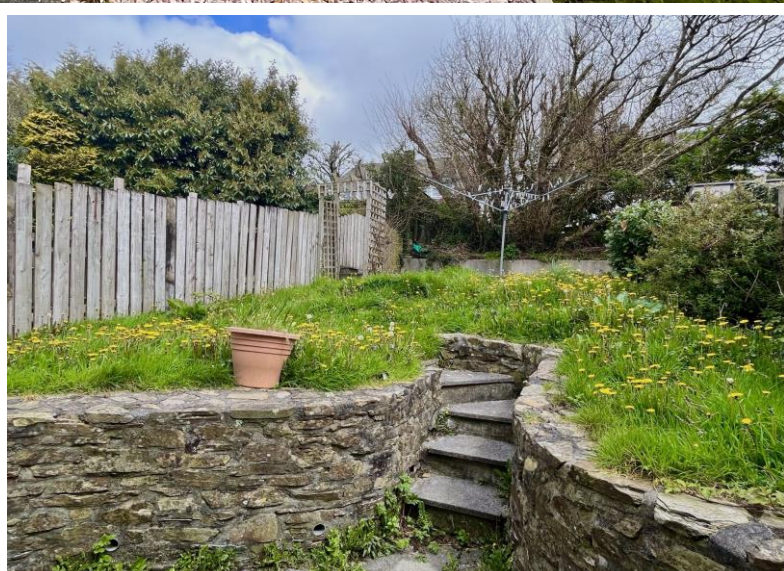

In Brief

Three bedroom detached house in the North of the City with easy access to Derriford and the Park and Ride

Large open-plan living area & kitchen on the first floor

Main double bedroom with en-suite and two single bedrooms

Driveway & garage in quiet cul de sac setting

Good sized rear garden

Lovely light and airy family house

Double glazed and centrally heated

EPC - D and Council Tax - D

Holding deposit of £311 and Total Deposit of £1,557

Let and Managed by Falcon Lettings

GROUND FLOOR
260 sq.ft. (24.2 sq.m.) approx.

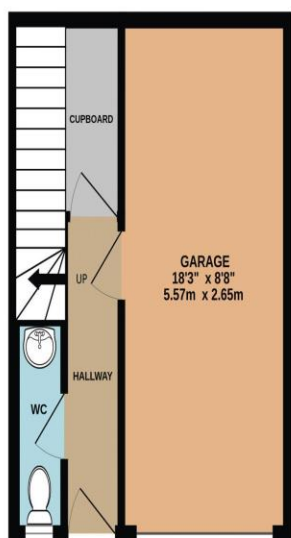

1ST FLOOR
421 sq.ft. (39.1 sq.m.) approx.

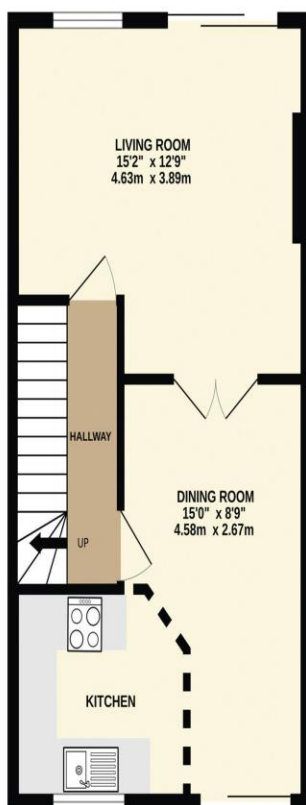

2ND FLOOR
403 sq.ft. (37.4 sq.m.) approx.

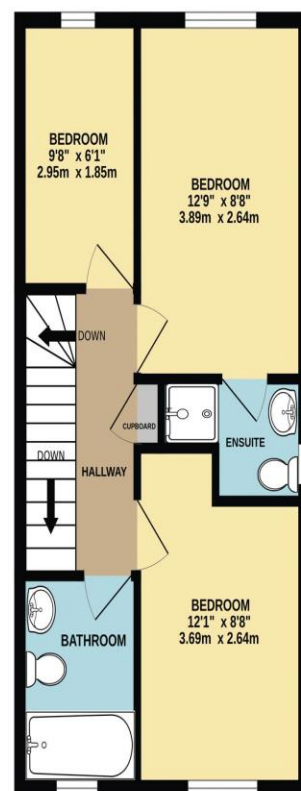

TOTAL FLOOR AREA: 1084 sq.ft. (100.7 sq.m.) approx.
Made with Metropix ©2023

www.falconlettings.com

8 Mannamead Road Mutley Plymouth PL4 7AA

Email: lettings@falconproperty.com

