



Falcon
lettings

01752 600828

28 Cabot Close

Saltash, Saltash, PL12 4TB

£1,100 pcm



In Brief

Cabot Close, Saltash

Newly refurbished two bedroom house

Modern kitchen

Two double bedrooms

Allocated parking to the front of the property

Gas central heating & Fully double glazed windows

Council tax band - B EPC - C

Holding Deposit £253 Total Deposit £1,269

This property will be Fully Managed by Falcon Lettings

Please note that updated photos will be uploaded soon.

GROUND FLOOR
301 sq.ft. (27.9 sq.m.) approx.

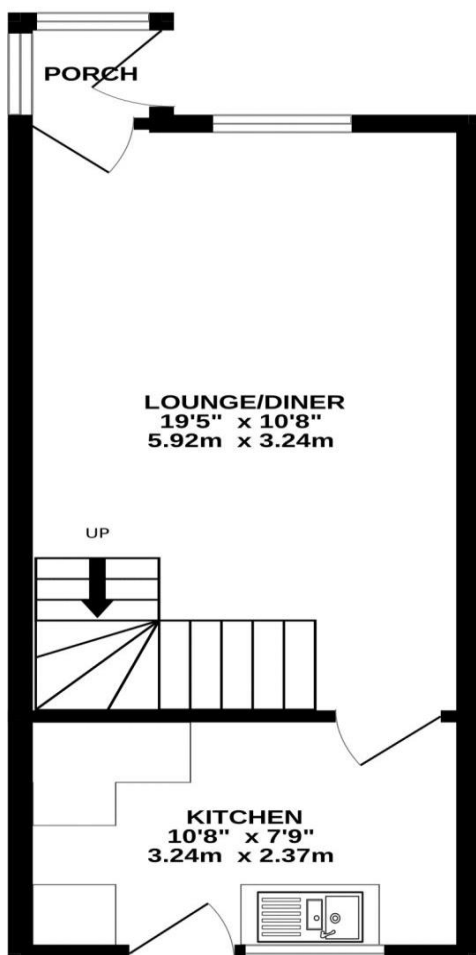

1ST FLOOR
289 sq.ft. (26.9 sq.m.) approx.

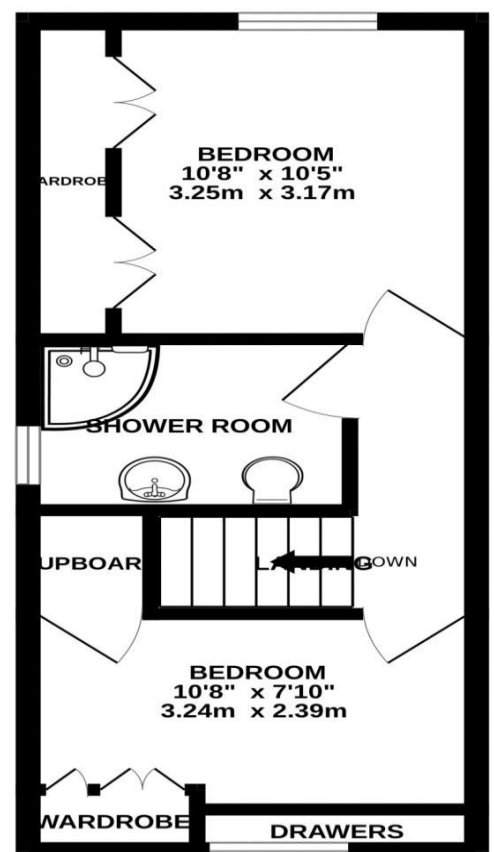

TOTAL FLOOR AREA : 590 sq.ft. (54.8 sq.m.) approx.
Made with Metropix ©2023

www.falconlettings.com

8 Mannamead Road Mutley Plymouth PL4 7AA

Email: lettings@falconproperty.com

