



Falcon

01752 600444

60 Douglass Road

Efford, Plymouth, PL3 6NP

Guide Price £210,000 - £220,000





In Brief

Beautifully Presented 3-Bedroom Family Home opposite a lovely open park.

Reception Rooms Large living room / Dining room

Bedrooms 3 bedrooms

Heating Electric wall heaters and underfloor heating in bathroom

Area 740 sq ft

Tenure Freehold

Parking Two allocated parking spaces

Council Tax B

Description

Tucked away in a sought-after development, this charming three-bedroom end-terrace home has been lovingly owned by the same family since new – and is now on the open market for the very first time. Built by Tilbury Homes around 34 years ago, it enjoys an enviable position right beside a fabulous open park and children's playground, making it the perfect spot for family living. Step inside and you'll find a well-designed kitchen and a spacious living/dining room to the rear, complete with a contemporary recessed living flame gas fire for a stylish focal point. French doors open directly onto the garden, where you can sit back and enjoy the sights and sounds of nature – from busy birds at the feeders to butterflies and even the occasional hedgehog visitor. Upstairs, the home offers three comfortable bedrooms and a modern family bathroom with mixer shower and underfloor heating. Both the kitchen and main bedroom boast open outlooks to one side across to the park, adding to the home's light and airy feel. The property also benefits from uPVC double glazing, and a sunny landscaped garden thoughtfully planted with flowers, shrubs, and trees designed to attract wildlife. The garden has a good sunny aspect to catch the sun throughout the afternoon and evening. With two allocated parking spaces – one at the front and one at the rear – practicality is perfectly matched with charm. Brilliantly located close to well-regarded primary schools and plenty of green space, this is a home that truly balances modern family living with a love for nature.

Need A Mortgage?

**Don't pay more than you need to for your mortgage advice:
ours is only £195 paid when you move!**

Floor Plans

GROUND FLOOR
369 sq.ft. (34.2 sq.m.) approx.

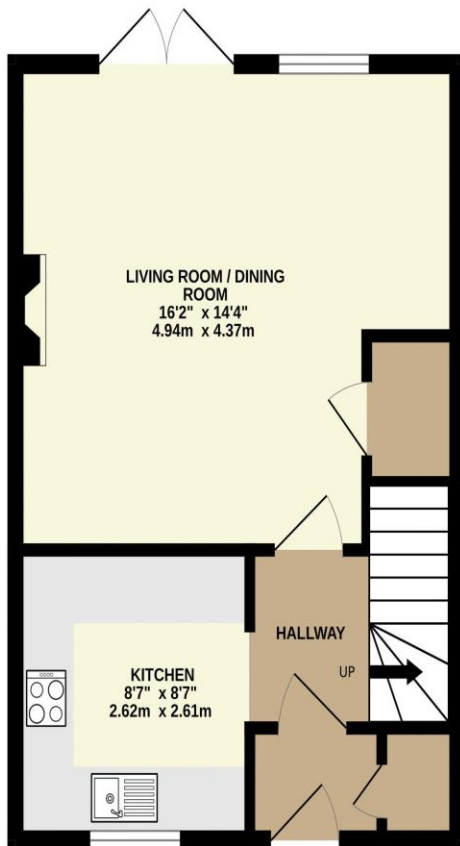

1ST FLOOR
371 sq.ft. (34.5 sq.m.) approx.

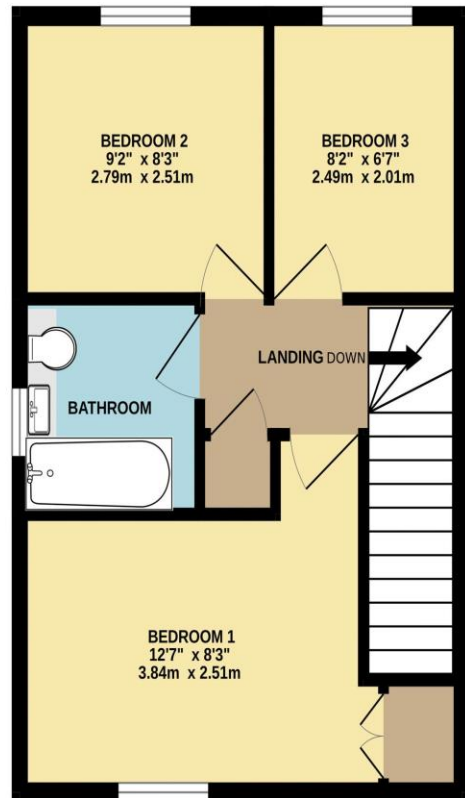

TOTAL FLOOR AREA: 740 sq.ft. (68.7 sq.m.) approx.
Made with Metropix ©2025



Fixed Price Conveyancing

A complete solution from just £600 with No sale – No Fee



We have not tested any apparatus, equipment, fixtures and fittings or services and so cannot verify that they are connected, in working order or fit for the purpose. Neither have we had sight of the legal documents to verify the Freehold or Leasehold status of any property; or sight of any consents, including Planning Permissions, building Regulations and Breaches of Covenants that may be required for alterations to the property. A buyer is advised to obtain verification from their Solicitor and/or Surveyor. Items shown in photographs are NOT included unless specifically mentioned within the Sales Particulars. Any floor plans on these details are not drawn to scale and are intended for guidance only

Falcon Property is an Introducer to Bradleys Financial Management Ltd. They are appointed representatives of Sesame Ltd who are authorised and regulated by the Financial Services Authority. Bradleys do not charge for mortgage advice, however a fee paying option is available. Typical fee is £195. Bradleys Financial Management: 16 Mannamead Road, Mutley, Plymouth, PL4 7AA

Your home may be repossessed if you do not keep up repayments on your mortgage.

