



Falcon
lettings

01752 600828

60 Holne Chase

Widewell, Plymouth, PL6 7UB

Monthly Rental Of £1,350

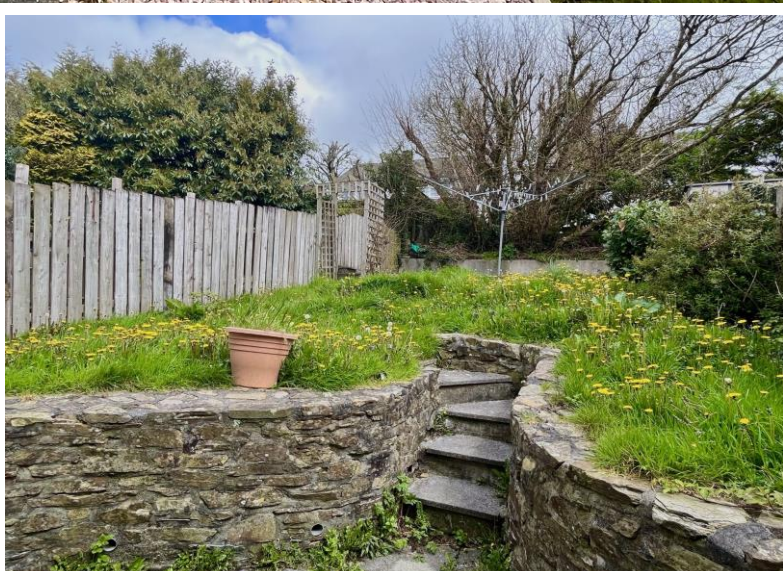

In Brief

Three bedroom detached house in the North of the City with easy access to Derriford and the Park and Ride

Large open-plan living area & kitchen on the first floor

Main double bedroom with en-suite and two single bedrooms

Driveway & garage in quiet cul de sac setting

Rear garden

Lovely light and airy family house

Double glazed and centrally heated

One small dog considered for an extra £25 per month

EPC - D and Council Tax - D

Let and Managed by Falcon Lettings

GROUND FLOOR
260 sq.ft. (24.2 sq.m.) approx.

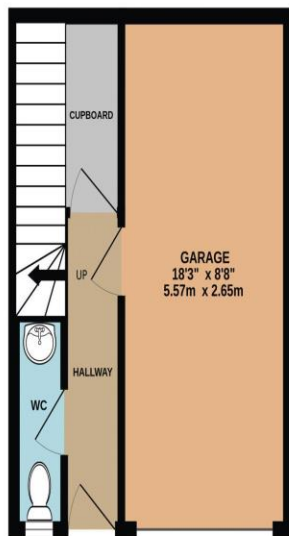

1ST FLOOR
421 sq.ft. (39.1 sq.m.) approx.

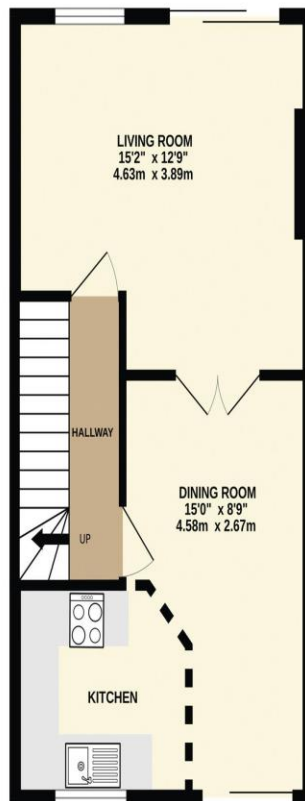

2ND FLOOR
403 sq.ft. (37.4 sq.m.) approx.

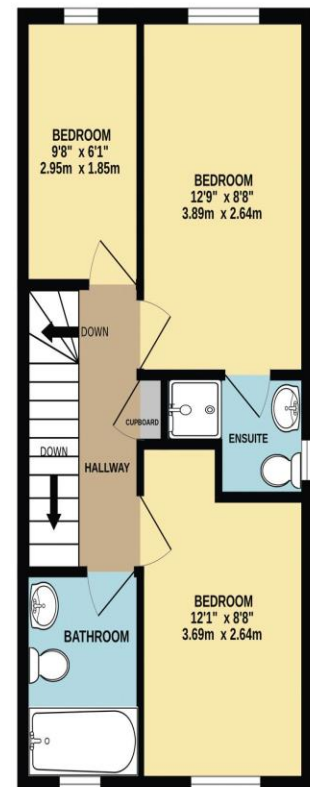

TOTAL FLOOR AREA: 1084 sq.ft. (100.7 sq.m.) approx.

Made with Metropix ©2023

www.falconlettings.com

8 Mannamead Road Mutley Plymouth PL4 7AA

Email: lettings@falconproperty.com

